

Please note:

Ensure that a licensed electrician is installing the fitting
Read all instructions before commencing

Cable Suspension Installation

- 1 Fasten barrel to ceiling**
Fasten the barrel by your chosen method.
i.e. Plastic anchors with screws for concrete
- 2 Male end of barrel**
Feed entire length of steel cable through male end of barrel until secured.
- 3 Fasten barrel**
Thread and lock the 2 barrel ends firmly.

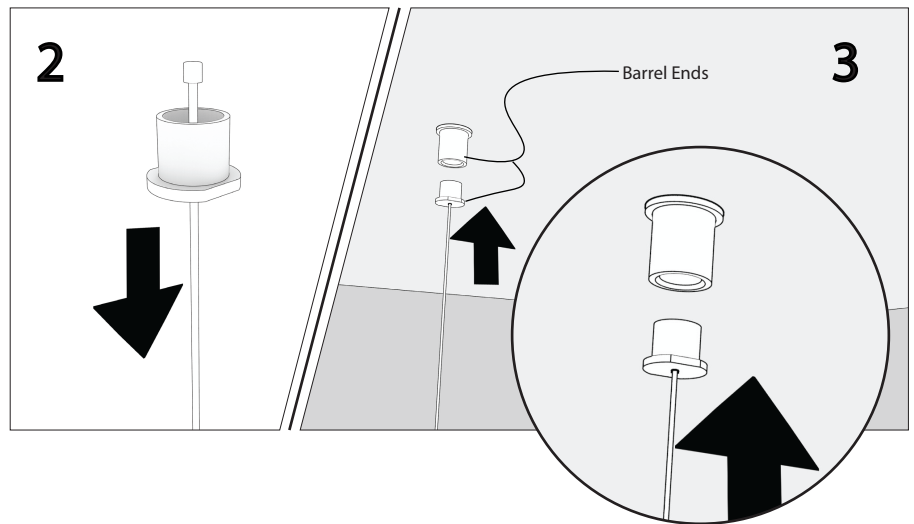
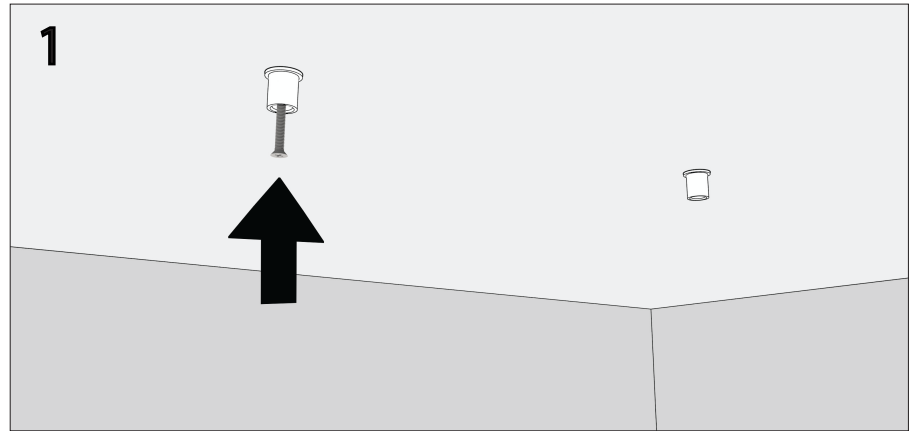

Tools required

Screw driver (Flat & Philips)
Plastic card (for reflector removal)

Fitting Disassembly

- 1 End plates removed**
Remove the end plates from the fitting with pulling and prying movements.
- 2 Acrylic diffuser removed**
Hold and pull acrylic diffuser with care until it bends out of fitting.
- 3 LED/Reflector tray removed**
Use plastic card to lever reflector tray out of fitting.

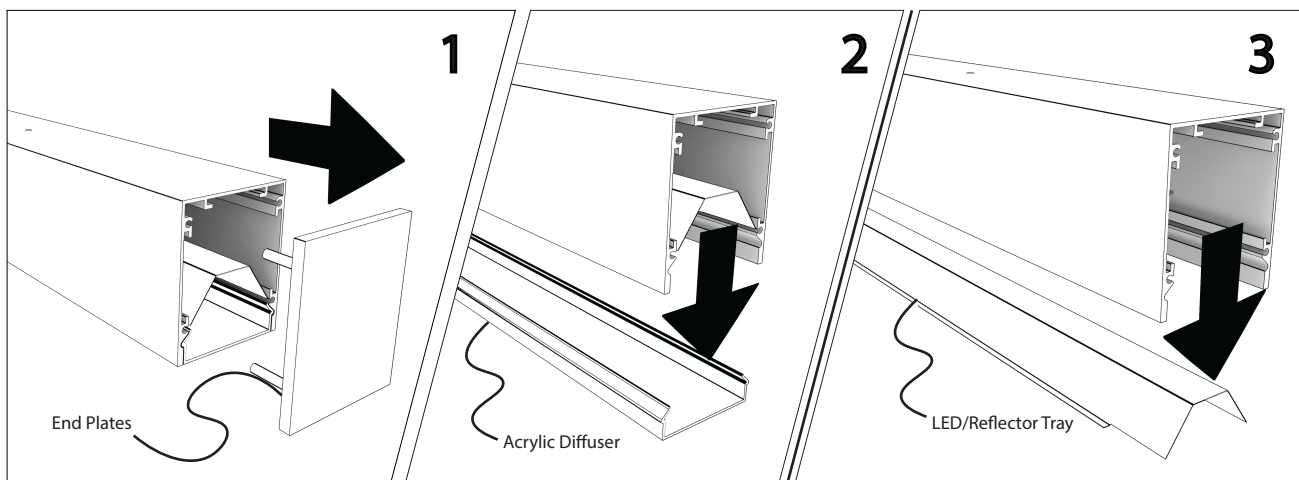

Please note:

Ensure that a licensed electrician is installing the fitting
Read all instructions before commencing

4

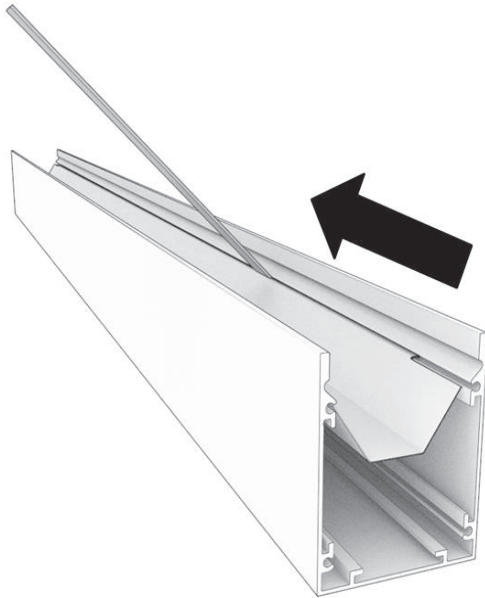

Fitting Disassembly

4 LED/Reflector tray removal

Slide the chosen plastic tool along the reflector from one side to the other until the reflector pops out.

Removing the Cable from Suspension Gripper

1 Suspension gripper release

Push the small neck down to release cable.

